

**TO BE COMPLETED BY CUSTOMER / CONTRACTOR**

COMPANY :		P.O. NUMBER :	
SITE ADDRESS :			
SITE CONTACT & PHONE :			
PREFERRED DELIVERY DATE (TBC SW360) :			
FILTER REFERENCE (IF APPLICABLE) :		LID LEVEL (INPUT REQUIRED) :	
IN / OUT PIPE DATA: DN375 (max)	DIA :	IL :	MATERIAL :
COMPLETED BY :		SIGNED :	DATE :

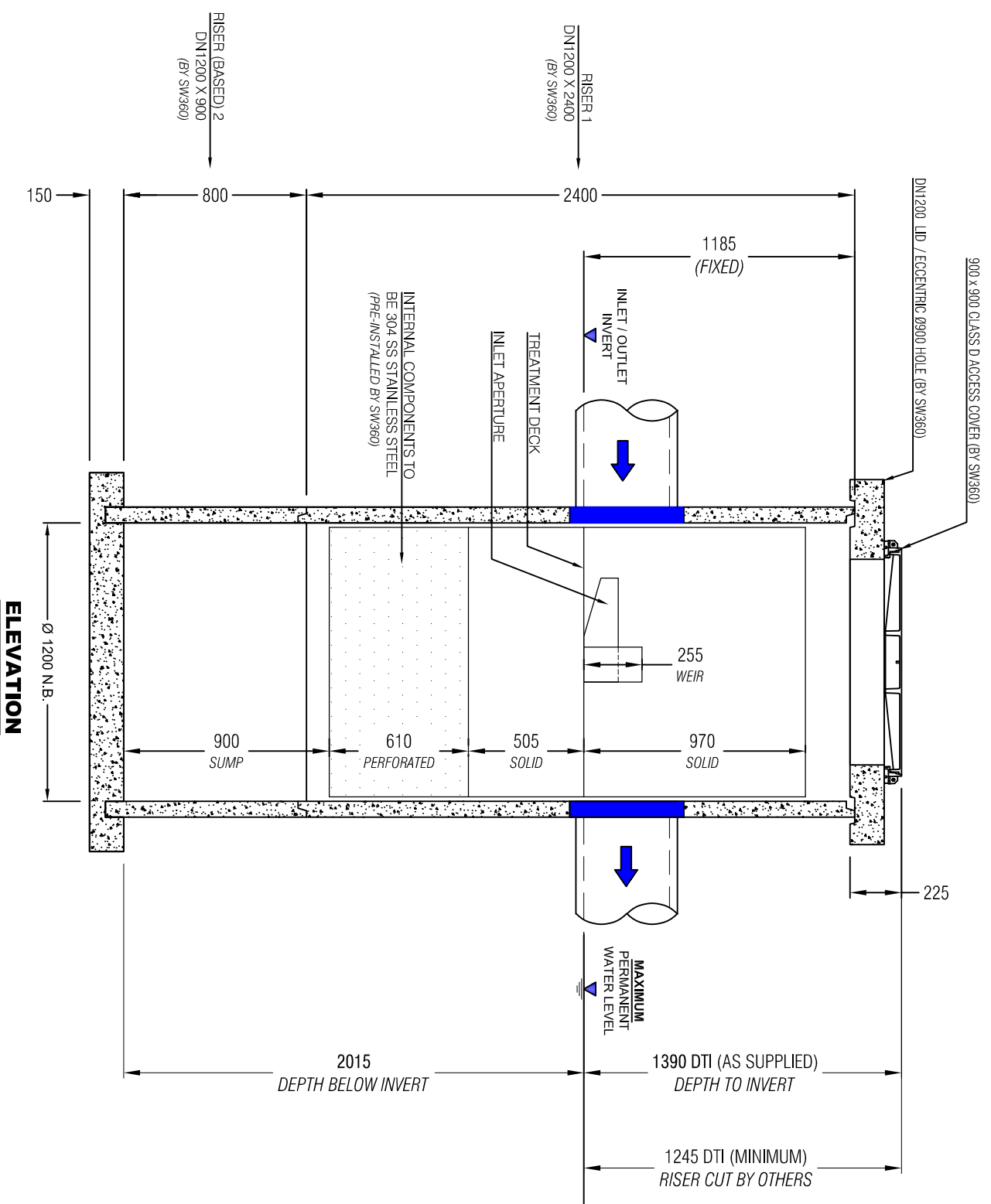
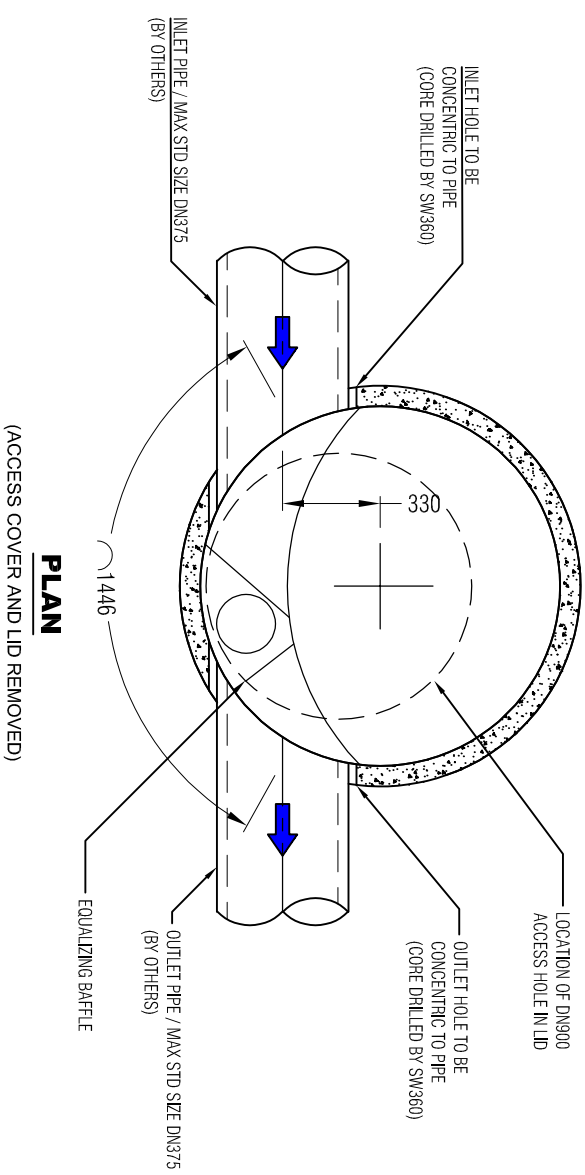

**GENERAL NOTES**

- MANHOLE COMPONENTS AND CONCRETE LID FITTED WITH SWIFTLIFT ANCHOR POINTS. SPREADER BAR RECOMMENDED FOR MANHOLE LIFTS.
- UNIT SUPPLIED WITH INLET AND OUTLET HOLES CORE DRILLED.
- SEALING / GROUTING OF MANHOLE COMPONENTS AND PIPES BY CONTRACTOR. ENSURING LOCAL CODES AND REGULATIONS ARE COMPLIED WITH.
- ANY RISERS REQUIRED TO INCREASE THE DEPTH TO INVERT (DTI) FROM THAT AS DRAWN TO BE SUPPLIED BY THE CONTRACTOR.
- FOR A DTI EXCEEDING 3m PLEASE CONTACT **0800STORMWATER**.
- CONTRACTOR TO TAKE APPROPRIATE MEASURES TO PROTECT DEVICE FROM CONSTRUCTION RELATED EROSION RUNOFF.
- BACKFILL, BEDDING AND BUOYANCY DESIGN BY ENGINEER OF RECORD.
- CONCRETE MANHOLE RISERS ARE DESIGNED AND MANUFACTURED IN ACCORDANCE WITH AS/NZS 4058 : 2007
- CONCRETE MANHOLE BASES ARE DESIGNED AND MANUFACTURED IN ACCORDANCE WITH NZS 3101 : 2006 & NZS 3109 : 1997
- CONCRETE LID DESIGNED AND MANUFACTURED TO HN-HC-72
- FOR REQUIREMENTS OUTSIDE OF DRAWING SPECIFICATIONS PLEASE CONTACT **0800STORMWATER**.

**DESIGN NOTES - VC40 (ON-LINE)**

- WATER QUALITY FLOW THROUGH THE VORTCAPTURE IS A FUNCTION OF TREATMENT REQUIREMENTS (POLLUTANT SIZE), DEVICE LOCATION AND TREATMENT AREA. PLEASE CONTACT **0800STORMWATER** FOR ASSISTANCE IN SELECTING THE MOST SUITABLE SIZE.
- MAXIMUM HYDRAULIC TREATMENT CAPACITY IS 39 L/s.
- MAXIMUM HYDRAULIC CAPACITY AT PEAK IS 260 L/s.
- CUSTOM DESIGNS AVAILABLE TO SUIT SITE SPECIFIC CONSTRAINTS. CONTACT **0800STORMWATER** FOR ASSISTANCE.
- 90 DEGREE ORIENTATION AND REVERSE FLOW DIRECTION AVAILABLE ON REQUEST.

**APPROX WEIGHTS**

DN1200 X 900 MHB: 1500 Kg
DN1200 X 2400 RISER (INCL INSERT): 1850 Kg
DN1200 CONCRETE LID: 550 Kg



0800 STORMWATER  
sales@stormwater360.co.nz  
www.stormwater360.co.nz

**CONDITION OF USE**  
© STORMWATER360 2020  
Any unauthorised reproduction of this drawing in part or in full is prohibited

VORTCAPTURE™  
GROSS POLLUTANT TRAP  
VC40 / DN1200 / FOR ON-LINE CONFIGURATION  
GENERAL ARRANGEMENT

JOB NO. :	REV	REVISION DETAIL	DATE
PROJECT :	0	APPROVED	29/09/20
DRN : G.S.			
CKD : K.J.			