

**NOTE :** INLET (MAX) AS SUCH THAT TOP OF CORED HOLE TO TOP OF RISER IS 300 mm MIN

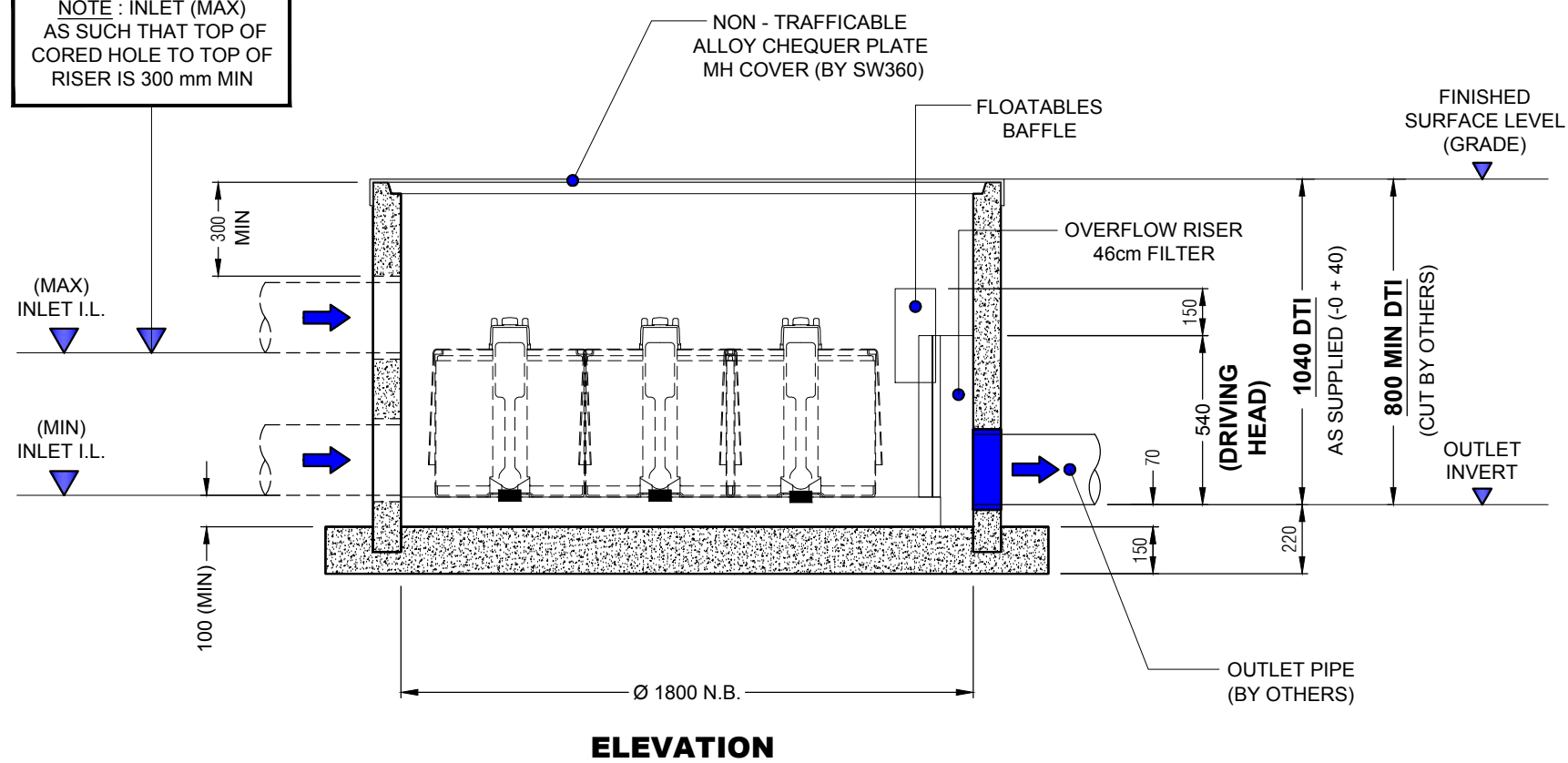

TO BE COMPLETED BY CUSTOMER / CONTRACTOR						
COMPANY :			P.O. NUMBER :			
SITE ADDRESS :						
SITE CONTACT & PHONE :						
PREFERRED DELIVERY DATE (TBC SW360) :						
STORMFILTER REFERENCE (IF APPLICABLE) :						
OUTLET HOLE Ø (CIRCLE) : (TYPICAL PIPE MATERIAL)	Ø 275 (DN225 PVC)	Ø 300 (DN225 RRJ)	Ø 350 (DN300 PVC)	Ø 400 (DN300 RRJ)	Ø 500 (DN375 RRJ)	Ø 600 (DN450 RRJ)
LID LEVEL (RL) :			OUTLET PIPE (IL) :		DTI :	
COMPLETED BY :			SIGNED :		DATE :	

TO BE COMPLETED BY SW360				
SW360 PRODUCT CODE :				
MEDIA TYPE (CIRCLE ONE) :	PERLITE	ZPG	OTHER :	
CARTRIDGE QTY (STATE) :				PRE-INSTALLATION (Y/N) :
SP FLOW RATE (CIRCLE ONE) :	FULL (Ø 25.0 ID) RED	3 QTR (Ø 21.8 ID) GREY	HALF (Ø 17.9 ID) ORANGE	OTHER :
ACCESS COVER (CIRCLE ONE) :	ALLOY CHEQUER PLATE			OTHER :
COMPLETED BY :	SIGNED :			DATE :

**SW360 PRODUCTION DATA**

**OUTLET HOLE DETAILS :**  
(CIRCLE REQUIREMENT)

OUTLET HOLE Ø	DIM A
275	190
300	180
350	220
400	225
500	260
600	315

DIMENSION A

1100 (NOMINAL)

DWG ISSUE No. :

REQUIRED DATE :

- NOTES**
- MANHOLE UNIT FITTED WITH SWIFTLIFT ANCHOR POINTS (QTY 2). DO NOT EXCEED 60 DEGREE LIFT ANGLE.
  - UNIT SUPPLIED WITH OUTLET CORE DRILLED. INLET/S CORE DRILLED ON SITE BY OTHERS WITHIN RANGE SHOWN ON DRAWING.
  - SEALING / GROUTING OF MANHOLE COMPONENTS AND PIPES BY CONTRACTOR. ENSURING LOCAL CODES AND REGULATIONS ARE COMPLIED WITH.
  - ANY RISERS REQUIRED TO INCREASE THE DEPTH TO INVERT (DTI) FROM THAT AS DRAWN TO BE SUPPLIED BY THE CONTRACTOR.
  - FOR A DTI EXCEEDING 5m PLEASE CONTACT **0800STORMWATER**.
  - CONTRACTOR TO TAKE APPROPRIATE MEASURES TO PROTECT CARTRIDGES FROM CONSTRUCTION RELATED EROSION RUNOFF.
  - BACKFILL, BEDDING AND BUOYANCY DESIGN BY ENGINEER OF RECORD
  - QTY OF CARTRIDGES BY ENGINEER OF RECORD.
  - CONCRETE MANHOLE RISERS ARE DESIGNED AND MANUFACTURED IN ACCORDANCE WITH AS/NZS 4058 : 2007
  - CONCRETE MANHOLE BASES ARE DESIGNED AND MANUFACTURED IN ACCORDANCE WITH NZS 3101 : 2006 & NZS 3109 : 1997
  - ALUMINIUM LID / NON-TRAFFICABLE
  - FOR REQUIREMENTS OUTSIDE OF DRAWING SPECIFICATIONS PLEASE CONTACT **0800STORMWATER**.

**APPROX WEIGHTS**

MANHOLE SECTION INCLUDING CARTRIDGES : **3450 Kg**  
(AS DELIVERED, BASED ON QTY 7 ZPG CARTS)